

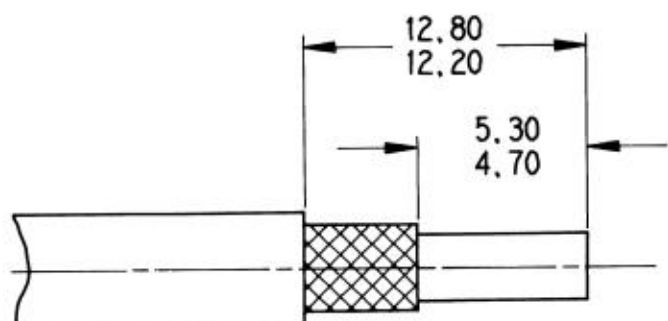

TITLE : SIZE 5 COAXIAL CONTACT _ WIRING INSTRUCTIONS FOR
RG 58 ,RG 141, RG142 AND RG223 CABLES

PEN :

FOR ENVIRONMENTAL APPLICATION ,BEFORE STRIPPING , SLIDE SEALING BOOT OVER CABLE



STEP 1
STRIP CABLE AT DIMENSIONS SHOWN

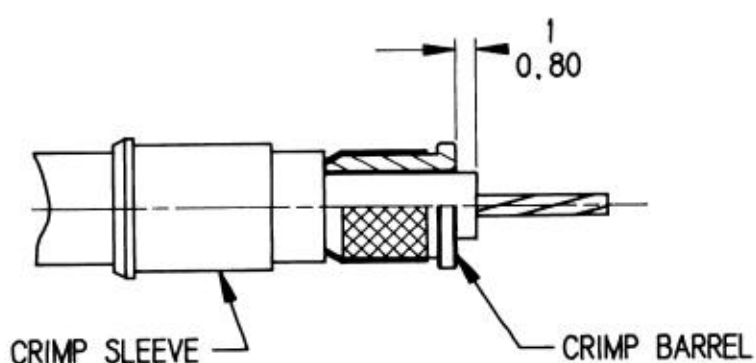

STEP 2
SLIDE CRIMP SLEEVE OVER CABLE
INTRODUCE CRIMP BARREL UNDER BRAID
STRIP CENTRE CONDUCTOR AT DIMENSION SHOWN

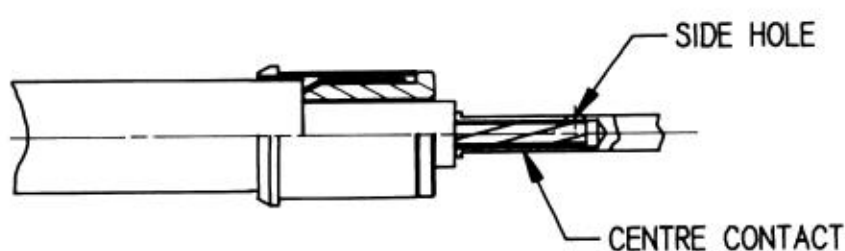

STEP 3
SLIDE CENTRE CONTACT OVER CENTRE CONDUCTOR
(CENTRE CONDUCTOR SHOULD BE SEEN THROUGH SIDE HOLE)
CRIMP CENTRE CONTACT USING :
CRIMPING TOOL: M22520/2-01 (RADIAL 282281)
POSITIONER : RADIAL 282572
SELECTOR POSITION : 6 FOR RG 58
8 FOR RG 141
8 FOR RG 142
8 FOR RG 223

SLIDE CRIMP SLEEVE OVER BRAID UNTIL IT BUTTS AGAINST
CRIMP BARREL

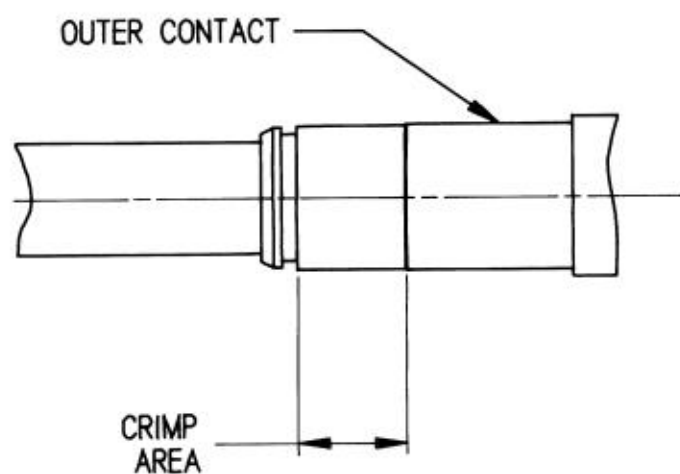

STEP 4
INTRODUCE CENTRE CONTACT SUB-ASSEMBLY INTO OUTER
CONTACT
THEN CRIMP OUTER CONTACT AT LOCATED AREA USING:
CRIMPING TOOL : M22520/5-01 (RADIAL 282293)
DIE : M22520/5-05 (RADIAL 282246) HEX. A (5,4/FLATS)

THIS DOCUMENT WAS CREATED BY CAD.IT CANNOT BE MODIFIED EXCEPT BY CAD.

| IND | MODIFICATIONS | DATE | VISA |
|----------|-----------------|------|------|
| Creation | Date: 4 nov. 91 | | |
| Up-date | Date: _____ | | |

This information is given as an indication. In the continual goal to better our products, we reserve the right to bring any modifications judged necessary.



101, rue Philibert Hoffmann, Z.I. Ouest
93116 ROSNY/BOIS Cedex (France)
Tél.: (1) 49 35 35 35
Fax.: (1) 48 54 63 63
Télex: RADIA 235220